

# Stainless Steel - Balustrade Fittings

## Glass Clamps

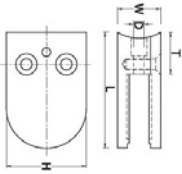

### Glass Clamp Medium "D" Type G316

P/N	Glass	Post	Finish	H	L	W	T	D
6131	6,8,10,12mm	Square/Flat	Satin	45	63	30	16	9
6131M	6,8,10,12mm	Square/Flat	Mirror	45	63	30	16	9
6132	6,8,10,12mm	2" Round	Satin	45	63	30	16	9
6132M	6,8,10,12mm	2" Round	Mirror	45	63	30	16	9

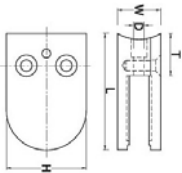

### Glass Clamp Medium "D" Type R/H Support

P/N	Glass	Post	Finish	H	L	W	T	D
2689R	6,8,10mm	Square/Flat	Satin	45	63	26	16	9
2689RM	6,8,10mm	Square/Flat	Mirror	45	63	26	16	9
2690R	6,8,10mm	2" Round	Satin	45	63	26	16	9
2690RM	6,8,10mm	2" Round	Mirror	45	63	26	16	9

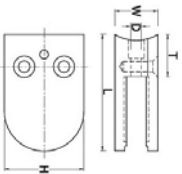

### Glass Clamp Medium "D" Type L/H Support

P/N	Glass	Post	Finish	H	L	W	T	D
2689L	6, 8, 10mm	Square/Flat	Satin	45	63	26	16	9
2689LM	6, 8, 10mm	Square/Flat	Mirror	45	63	26	16	9
2690L	6, 8, 10mm	2" Round	Satin	45	63	26	16	9
2690LM	6, 8, 10mm	2" Round	Mirror	45	63	26	16	9

### Rubber Gaskets for "D" Type Glass Clamps



P/N	Glass
6131-G-06	6mm
6131-G-08	8mm
6131-G-10	10mm
6131-G-12	12mm

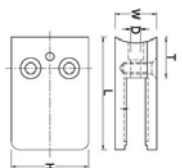

### Glass Clamp Large Square Type G316

P/N	Glass	Post	Finish	H	L	W	T	D
6225	8, 10, 12mm	Square/Flat	Satin	55	55	32	16	9
6225M	8, 10, 12mm	Square/Flat	Mirror	55	55	32	16	9
6224	8, 10, 12mm	2" Round	Satin	55	55	32	16	9
6224M	8, 10, 12mm	2" Round	Mirror	55	55	32	16	9

### Rubber Gaskets for Square Type Glass Clamps



P/N	Glass
6224-G-08	8mm
6224-G-10	10mm
6224-G-12	12mm

# Stainless Steel - Balustrade Fittings

## Fasteners



Fixed Head



Swivel Head

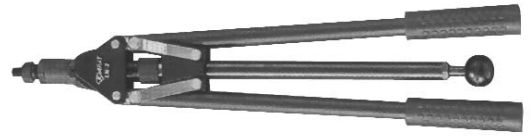

Nut Rivets and Tool



P/N	Size	Head	Grade
0370	8G x 1 3/4"	CSK	304
0343	8G x 1 3/4"	PAN	304
0360	4mm x 6.4mm grip	POP RIVET	304

## Stainless Steel Maintenance Products



### High Quality Stainless Steel Polish - liquid

One step application which leaves a protective coating on surface • P/N MS-METPOL

### Spray Cleaner

Spray on - Wipe off for use on wire and tube • P/N AN-1906

### Stainless Steel Polish - paste

For use on Stainless Steel and Brass fittings • P/N MS-POLISH

### Nickel Anti -Seize

Use to prevent binding when Stainless Steel threads are under load • P/N MS-844-25 25g • P/N MS-831-225 225g

### Anti-corrosive Joining Compound

Inhibits electrolytic corrosion between dissimilar metals  
• P/N MS-DUROLAC

### Stainless Steel Information

1. It is an often held belief that stainless steel is "maintenance free". This however is not necessarily correct. All grades of stainless steel are susceptible to some form of staining or discolouration and periodic cleaning is required.
2. Stainless steel, if not properly maintained will discolour via a process called tea staining.
3. The staining rate and the required maintenance of stainless steel is relative to its environment, surface finish, design, grade of material and exposure.
4. For example,
  - a. An outside balustrade installation along Melbourne's Bayside or Coastal Areas would experience a faster rate of tea staining due to the environmental conditions and would therefore require more frequent maintenance than an indoor stairway balustrade installed in an inner Melbourne suburb of say - Blackburn.
  - b. Due to the relative smoothness of the surface finish, a stainless steel component with a satin finish will display signs of tea staining much sooner than a highly polished component of the same grade.
  - c. Designs that incorporate poor run off (rain water / washing water / etc) provide areas for stagnant water to collect which may increase the likelihood of tea staining.
5. We therefore suggest that you enquire about appropriate products available for the cleaning and maintenance of stainless steel.

### Disclaimer

1. The above information is only given as a guide or general information. If the information given is insufficient, or if you are not satisfied, or certain, we suggest you seek further advice from a professional metallurgist.
2. For safety, structural and strategic applications, independent engineering or specialist advice should be sought from the relevant authorities/experts. Based on this advice, our sales consultants can assist with the supply of rated fittings for these applications as recommended/nominated by your professional, qualified engineer. Under no circumstances is Keble's Trading Pty Ltd or its staff authorized or qualified to make any recommendations whatsoever regarding design or selection of fittings for such applications.
3. Keble's Trading makes no recommendations or claims for the performance and mechanical properties of Stainless Steel and accepts no responsibility or liability whatsoever for any unsatisfactory outcome, unsuitable application or installation of these products.
4. Keble's Trading Pty Ltd makes no recommendations and takes no responsibility for the use of any fastening system or products used in the installation of any Balustrading and Handrail components. The responsibility of the design and choice of fastener for compliance to Aust Standard and relevant codes lies solely with the purchaser. Please consult appropriate authorities and or the advice of professional persons for information on correct design and installation techniques.
5. Every effort has been made to ensure that all information contained in this brochure is correct at time of printing. We strongly advise that you check all items with our sales staff at the time of ordering as changes may occur without prior notice.

# STAINLESS STEEL BALUSTRADE FITTINGS

## Tensioners

### Jaw & Tube Bottlescrew

P/N	d	Wire size	L	L1	A	D
0003	M5	3.2mm	153	80	7	5
0003m	M5	3.2mm	83	50	6	5
0004	M6	4mm	170	90	8	6

### Jaw & Jaw Bottlescrew

P/N	d	L	L1	A	D
0156	M5	130	80	7	5
0157	M6	145	90	7	6
0157i	M6	145	92	10.5	6

### Turnbuckles

P/N	Type	Thread	Eye ID	Hook opening	L
0006	Eye/Eye	M4	8		98
0121	Eye/Eye	M5	8		120
0121i	Eye/Eye	M5	10		126
0122	Eye/Eye	M6	10		150
0132	Hook/Eye	M5	8	7	120
0132i	Hook/Eye	M5	10	9	127
0133	Hook/Eye	M6	10	9	155
0133i	Hook/Eye	M6	10	11	165
0001	Hook/Hook	M4		7	98
0127	Hook/Hook	M5		7	120
0128	Hook/Hook	M6		9	160

P/N	Type	Thread	A	L
0137	Jaw/Jaw	M5	6	120
0138	Jaw/Jaw	M6	7	150

### Hex Tensioner

P/N	Thread	D	D2	L	L1
1911	M5	8	12	33	30
1912	M6	8	12	40	35

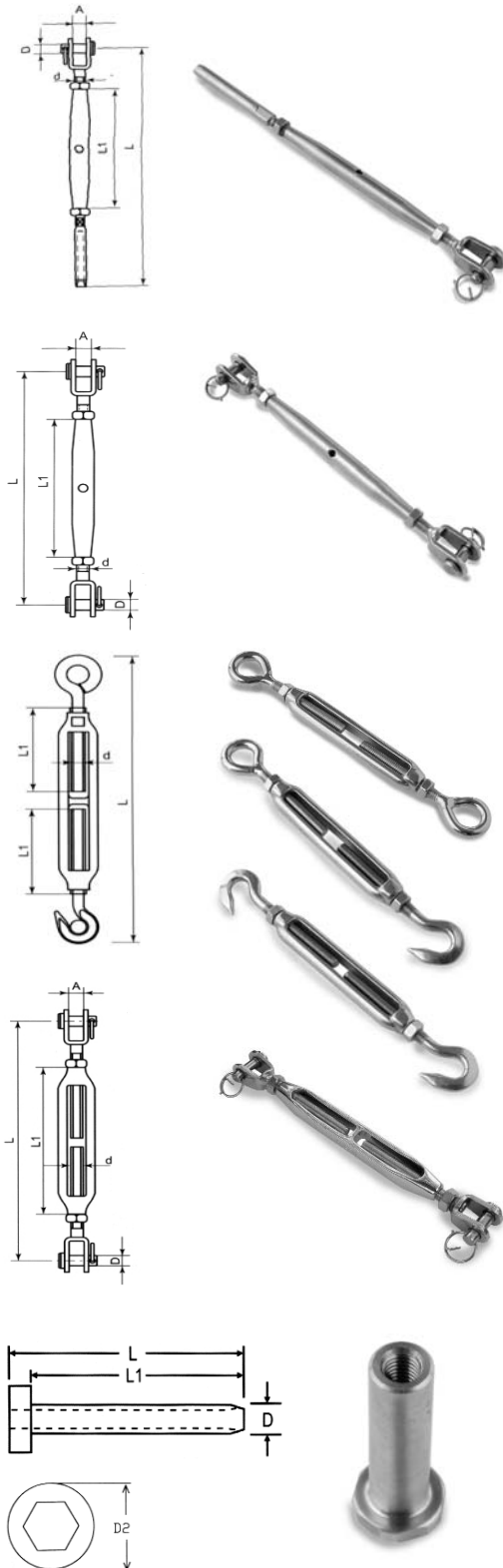

# Stainless Steel - Balustrade Fittings

## Hydraulic Terminals

### Swage/Stud R.H.T.

P/N	Thread	Wire Size	L	L1	L2
0321	M5	3.2mm	90	40	40
0308	M6	3.2mm	90	40	40
0308i	M6	3.2mm	97	48	38
0309	M6	4mm	116	50	46

### Swage/Stud L.H.T.

P/N	Thread Size	Wire Size	L	L1	L2
0322	M5	3.2mm	90	40	40
0305	M6	3.2mm	90	40	40
0305i	M6	3.2mm	97	48	38
0310	M6	4mm	116	50	46

### Swage/Stud Long

P/N	Thread Size	Wire Size	L	L1	L2
0326	M6	3.0mm	118	75	40
0307	M6	3.2mm	118	75	40
0313	M8	4mm	143	90	47

### Internal Threaded Terminal

P/N	Thread Size	Wire Size	L	L1	D
1791	M5	3.2mm	88	35	8
0069	M6	4mm	95	35	8

### Fork Terminal

P/N	Pin size	Wire Size	A	L	L1
1815	5mm	3.2mm	7mm	67	40
1815m	5mm	3.2mm	7mm	45	21
0335	6mm	3.2mm	8mm	67	40
0336	6mm	4mm	8mm	73	45

### Eye Terminal

P/N	ID	Wire Size	L	L1
0330	6.5mm	3.2mm	54.5mm	40
0330i	6.5mm	3.2mm	63mm	38
0331	8.5mm	4mm	68mm	48

### Lag Screw Swage Terminal

P/N	Thread Size	Wire Size	L	L1
1319	M6 RHT	3.2mm	90	40
1319i	M6 RHT	3.2mm	97	48
1318	M6 LHT	3.2mm	90	40
1318i	M6 LHT	3.2mm	97	48

### Dome Terminal

P/N	Wire Size	Head Diam	L
1913	3.2mm	10	48.5
0072	4mm	11.5	55.5

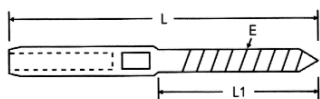
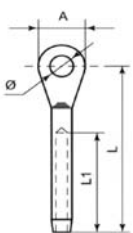
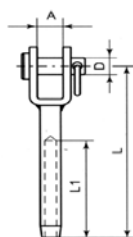
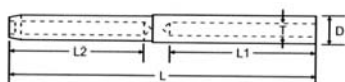
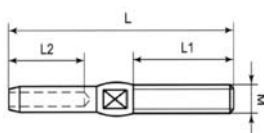

# Stainless Steel - Balustrade Fittings

## Post Anchors

### Lag Screw Eye

P/N	D	A	L	C
0184	M6	6.3	60	40
0184i	M6	6.3	55	48
0185	M8	8.4	60	39

### Saddles (Eye strap)

P/N	D	H	L	W
0376	5	18	50	14
0377	6	23	60	16

### Eye Bolts Welded Eye

P/N	Thread	D	L1
0189	M6	13mm	40mm
0190	M6	13mm	55mm
1835	M6	13mm	60mm
0191	M6	13mm	80mm
0024i	M6	13mm	125mm
0194	M8	17mm	80mm

### Lag Screw Welded Eye

P/N	Thread	D	L
0150i	6x60mm	12mm	60
0151i	8x80mm	15mm	80
0152i	8x100mm	15mm	100

P/N	Thread	L1	L2	E
2910	M6	14	10	6
1555	M6	22	16	6
1556	M6	55	50	6.3

## Wire Rope

P/N	Construction	Metric	Imperial
0415	1 x 19	3.2	1/8"
0418	1 x 19	4	5/32"
0416	7 x 7	3.2	1/8"
0419	7 x 7	4	5/32"
0417	7 x 19	3.2	1/8"
0421	7 x 19	4	5/32"

Enquire about our full range of wire rope available ex stock.

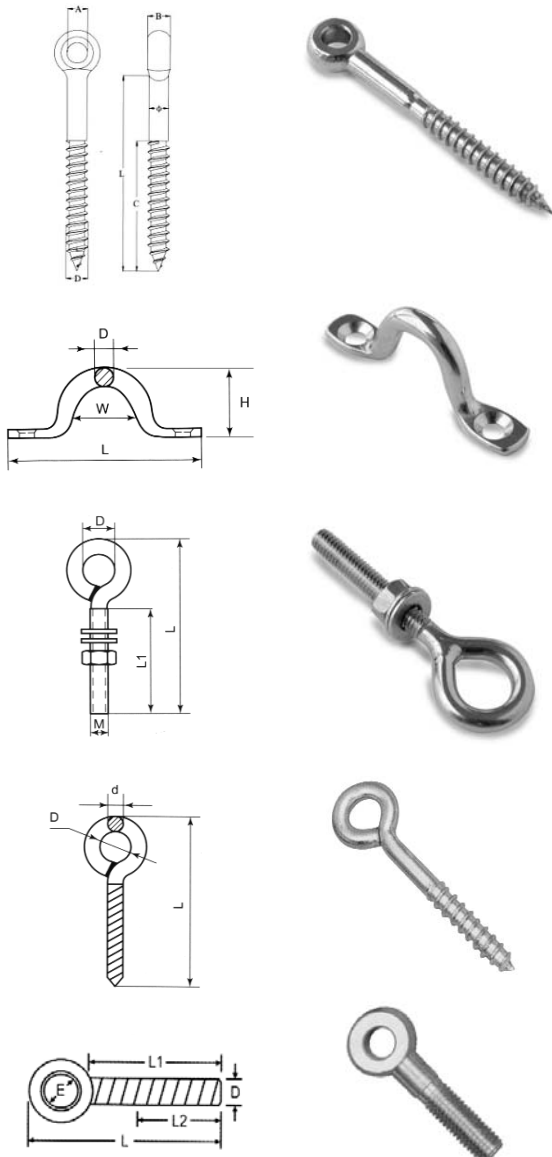

Construction: 1 x 19



NON-FLEXIBLE:

Construction: 7 x 7

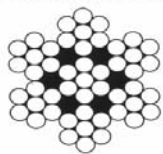

SEMI-FLEXIBLE:

Construction: 7 x 19

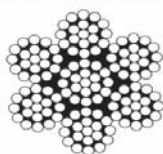

FLEXIBLE:

Note: 1 x 19 not suitable for hand swaging  
 7 x 7 suitable for hand swaging  
 7 x 19 suitable for tight corners

# Stainless Steel - Balustrade Fittings

Customised Swaging Service  
available for wire rope 1.2mm - 16mm

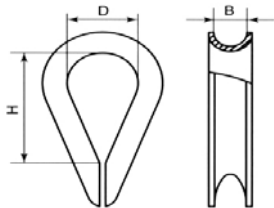

## Wire Rope Tools & Fittings

### Hand Swages Copper N/P

P/N	Size
1165	2.5MM
0602	3/3.2MM
1167	4.0MM
1168	4.8MM
1169	6.4MM

### Wire Rope Thimble

P/N	Rope Size	D	H	B
0055	2mm	7	16	3
0056	3mm	9.5	18	4.5
0056i	3mm	10	21	3
0057	4mm	10	19	5
0057i	4mm	12	26	4
0058	5mm	12	22	7
0058i	5mm	13	28	5
0059	6mm	15	27	7
0059i	6mm	14	30	6

### Nylon Inserts - Split Black

P/N	Max Tube thickness	Hole Size	Wire Diam
0342	3.2MM	9.5MM	3.2MM



### Hand Swaging Tool

P/N	Size	Crimp size
1134	12"	1.5 / 2.0 / 2.5mm
1135	24"	1.5-2 / 2.5 / 3mm
1136	30"	4 / 5mm



### Wire Rope Cutter

P/N	Size	Wire Size
1143	HIT 6MM	4MM
1140	HIT 9MM	6MM
1141	HIT 16MM	12MM
1142	FELCO 7MM	4MM
0033	FELCO 9MM	6MM



### Tension Gauge

P/N
2980

### Hydraulic Swaging Tool - c/w Hand Pump

P/N	Size
1794	18 TON

### Hydraulic Hex Die

P/N	Size
1795	3MM



**We have the right product, at the right price, when you need it, on-time, every time**